

2014-11-11

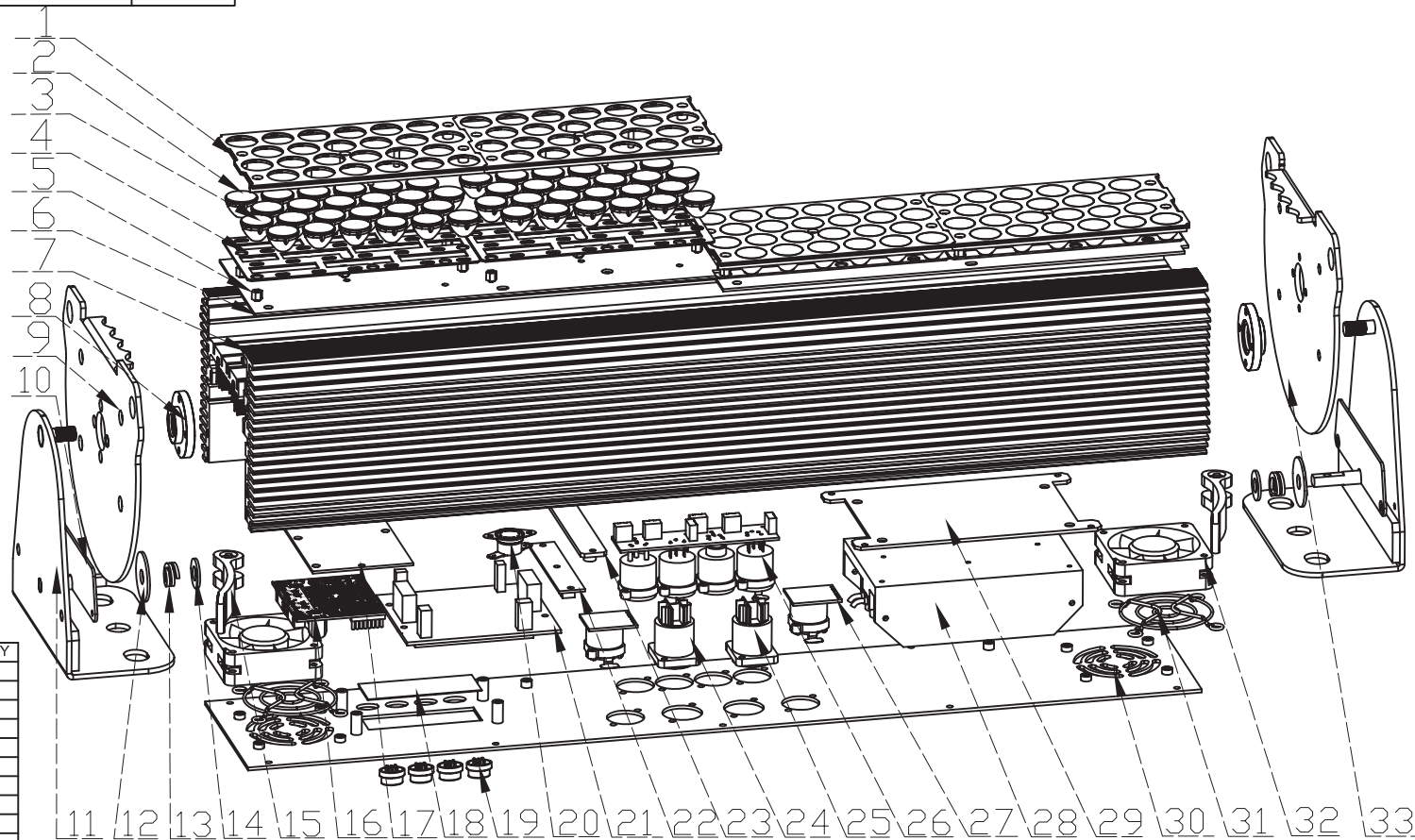

SN.	PART CODE	DRAFT NO.	ITEM NO.	QTY
1	7030100111A	LA2115-S-01	the fixing plate for lens	4
2	5050100034	DB013A	LENS (small degree)	48
3	5050100035	DB013B	LENS (large degree)	48
4	7030100112	LA2115-S-02	base plate	4
5	7020300040		copper pillar	20
6	8010046400	LA2115-04D	PCB	2
7	7040100053A	L201024-01	light housing	1
8	7050000052	LA2115-11	bearing assembly	2
9	7010200912A	LA2115-09	the side plate (left)	1
10	6120200000	LA2115-13	plastic clip	2
11	7010200911.1A	LA2115-08-00	light shell assembly	2
12	7020200042		flat washer	2
13	7020201015		spring washer	2
14	7020200041		flat washer	2
15	7040100051A	LA2115-L-13	handle	2
16	8010046501	LAETMO-01A	PCB	1
17	7010200909	LA2115-12	The power adapter plate	1
18	5070100005		PC for display	1
19	7030100057		button	4
20	6060400000		temp.control switch	1
21	8010046600	LA2115-02A	PCB	1
22	8010046700	LA2115-06A	PCB	1
23	7010200910	LA2115-20	the fixing plate for adapter plate	1
24	6120200000	NAC3MPA-1	powercon in	1
25	6120300000	NAC3MPB-1	powercon out	1
26	8010027800	LA2108-05A	PCB	1
27	8010040400	LARJ45-03A	PCB	2
28	5040000099		PSU	1
29	7010200907	LA2115-07	the power fixing plate	1
30	7010200917A	L20102-01	back cover plate	1
31	7020900001		fans guard	2
32	5010000006	DFM6020B	fans	2
33	7010200913A	LA2115-10	the side plate (right)	1
34				
35				

ELATION COLOUR CHORUS 24™